

LM-AJ

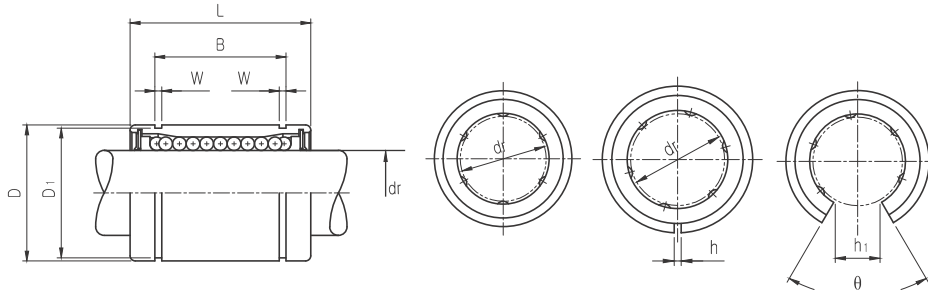

سایز شفت mm	واشر پلاستیکی کد کاس	تعداد ردیف ساجمه	وزن gf	dr دقت μm		قیمت	
				Precision	High	دلار	تومان
6	LM6UU-AJ	4	7.5	0 - 6	0 - 9		
8	LM8UU-AJ	4	14.7				
10	LM10UU-AJ	4	29				
12	LM12UU-AJ	4	31				
13	LM13UU-AJ	4	42				
16	LM16UU-AJ	5	68	0 - 7	0 - 10		
20	LM20UU-AJ	5	85				
25	LM25UU-AJ	6	216				
30	LM30UU-AJ	6	245				
35	LM35UU-AJ	6	384				
40	LM40UU-AJ	6	579	0 - 8	0 - 12		
50	LM50UU-AJ	6	1560				
60	LM60UU-AJ	6	1820				
80	LM80UU-AJ	6	4300				
100	LM100UU-AJ	6	8540				
120	LM120UU-AJ	8	14900	0 - 10	0 - 20		
150	LM150UU-AJ	8	20150				

کد کاس	D mm	L mm	B mm	W mm	D1 mm	h mm	h1 mm	θ	Eccentricity μm		Radial Clearance (max) μm	تحمیل بار	
									Precision	High		Dynamic N	Static N
LM6UU-AJ	12	19	13.5	1.1	11.5	-	-	-	8	12	-3	206	265
LM8UU-AJ	15	24	17.5	1.1	14.3	1	-	-				274	392
LM10UU-AJ	19	29	22	1.3	18	1	6.8	80°				372	549
LM12UU-AJ	21	30	23	1.3	20	1.5	8	80°			510	784	
LM13UU-AJ	23	32	23	1.3	22	1.5	9	80°			510	784	
LM16UU-AJ	28	37	26.5	1.6	27	1.5	11	80°	10	15	-6	774	1,180
LM20UU-AJ	32	42	30.5	1.6	30.5	1.5	11	60°				882	1,370
LM25UU-AJ	40	59	41	1.85	38	2	12	50°				980	1,570
LM30UU-AJ	45	64	44.5	1.85	43	2.5	15	50°			1,570	2,740	
LM35UU-AJ	52	70	49.5	2.1	49	2.5	17	50°			1,670	3,140	
LM40UU-AJ	60	80	60.5	2.1	57	3	20	50°	12	20	-10	2,160	4,020
LM50UU-AJ	80	100	74	2.6	76.5	3	25	50°				3,820	7,940
LM60UU-AJ	90	110	85	3.15	86.5	3	30	50°				4,700	10,000
LM80UU-AJ	120	140	105.5	4.15	116	3	40	50°			7,350	16,000	
LM100UU-AJ	150	175	125.5	4.15	145	3	50	50°			14,100	34,800	
LM120UU-AJ	180	200	158.6	4.15	175	3	85	80°	20	30	-20	16,400	40,000
LM150UU-AJ	210	240	170.6	5.15	204	3	105	80°				21,100	54,300